

# Lifting capacity charts and installation example for elero drives Type 11 with manual override

## Awnings and roller blinds

Drives for marquiselettes, conservatory blinds, fabric tension systems etc. have to be determined separately for each individual project.

Type	Torque [Nm]	Speed [Upm]	Shaft $\phi$ [mm]	Lifting capacity on the barrel [kg]	Max. no. of arms on retractable, arm awnings, cassette awnings		
					20 kg per arm	25 kg per arm	30 kg per arm
11/4	40	15	78	103	4	2	2
			85	94	4	2	2
11/6	60	12	78	154	6	4	4
			85	141	4	4	4
11/8	80	15	78	205	6	6	4
			85	188	6	6	4
11/10	100	12	78	256	8	8	6
			85	235	8	6	6
11/12	120	12	78	308	8	8	8
			85	282	8	8	8

Legend: 2 Drive recommendation  
Number of retractable arms

## Lifting capacity for one piece roller shutter systems

Type	Torque [Nm]	Speed [Upm]	Shaft $\phi$ [mm]	Profile thickness up to [mm]	Roller shutter height up to		
					1,5 m [kg]	2,5 m [kg]	3,0 m [kg]
11/4	40	15	78	11	78	70	66
11/6	60	12	78	11	117	105	100
11/8	80	15	78	11	156	140	133
11/10	100	12	78	11	195	175	166
11/12	120	12	78	11	234	210	199
11/4	40	15	78	14	73	64	61
11/6	60	12	78	14	110	96	91
11/8	80	15	78	14	146	128	122
11/10	100	12	78	14	183	160	152
11/12	120	12	78	14	220	193	183
11/4	40	15	100	14	65	58	56
11/6	60	12	100	14	95	87	84
11/8	80	15	100	14	127	116	112
11/10	100	12	100	14	159	145	140
11/12	120	12	100	14	191	175	168
11/4	40	15	114	14	56	54	52
11/6	60	12	114	14	84	81	78
11/8	80	15	114	14	112	108	105
11/10	100	12	114	14	140	135	131
11/12	120	12	114	14	169	161	157

### Note:

- For multi part roller shutters, the roller shutter weight has to be increased by 5% for each additional roller shutter  
Example: 3 piece roller shutter; shaft  $\phi$  78 mm; profile thickness 14 mm, height 2.8 m; weight per roller shutter 30 kg.  
Calculation:  $30 \text{ kg} + 31.5 \text{ kg} + 31.5 \text{ kg} = 93 \text{ kg}$ ; A drive type 11/8 has to be used.
- The permissible load of the winding shaft must not be exceeded.
- These details are guideline values only and are given without any liability!

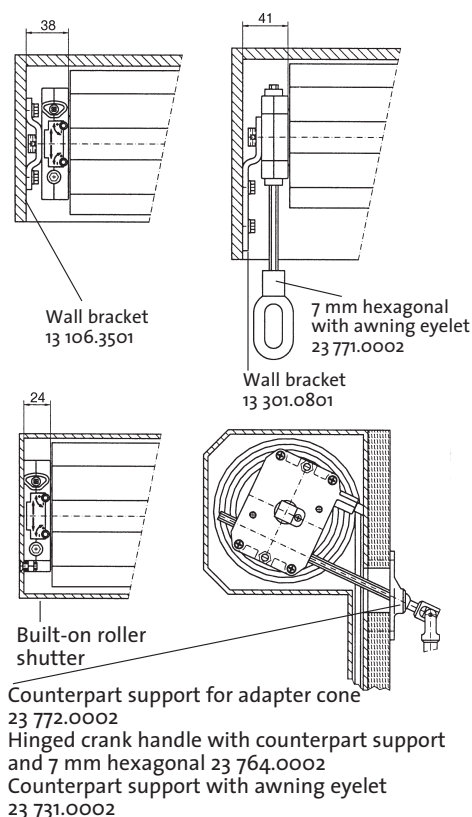

**All charts are based on the net roller shutter weight.**

## Type 11/6 NHK

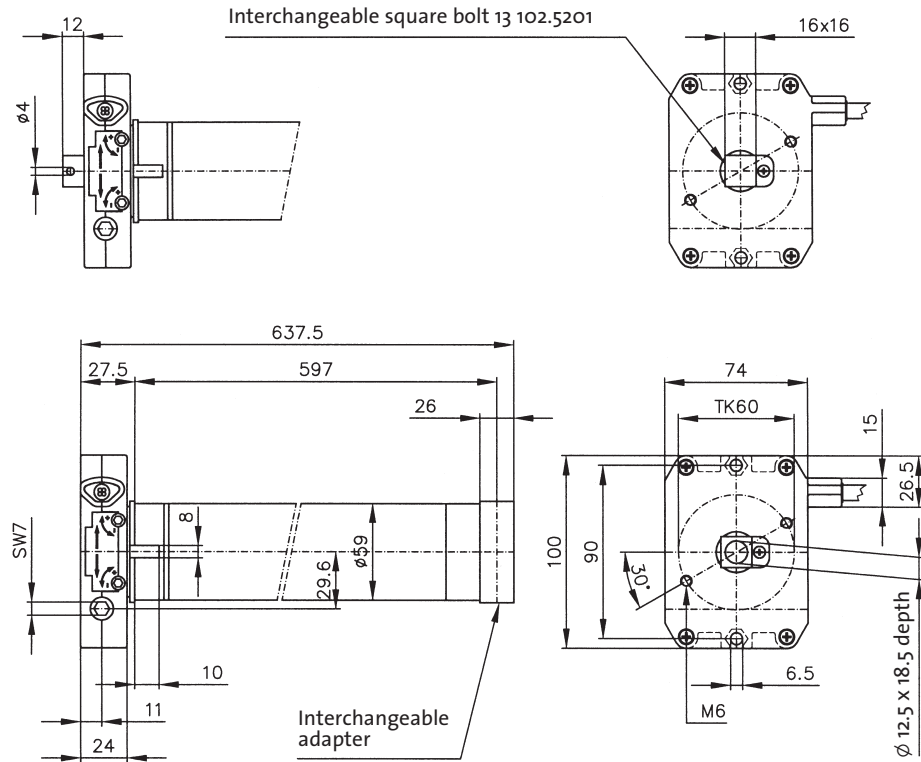

## Type 11/8–11/12 NHK

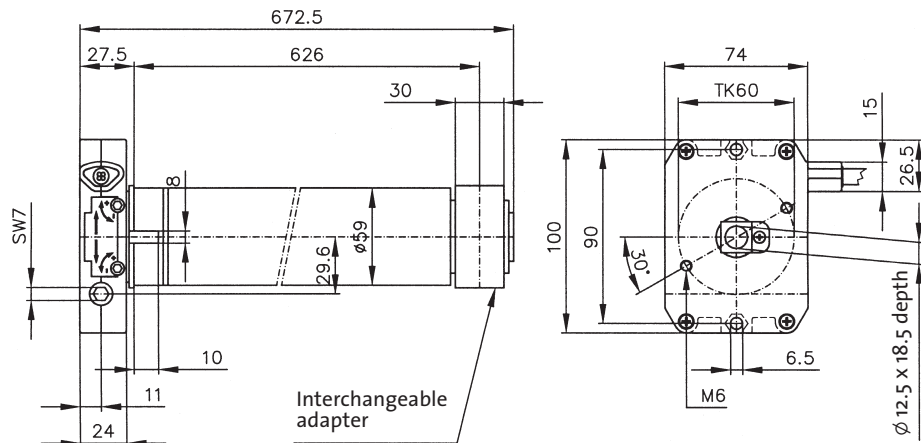

## Technical data

Type	Max. torque Nm	Lifting capacity on the barrel N	Barrel $\phi$ x wall thickness in mm	Speed (rpm)	Max. limit switch range in barrel turns	Lateral space requirement mm	Voltage (V) Frequency 50 Hz*)	Current (A)	Power (W)	Rating in min - intermittent	Protection type IP	Manual override reduction	VDE-EMC tested 	VDE 0700 label 	CE 
11/4 NHK	40	1260	63 x 1,5	15	29	24	230 ~	1,45	260	5	44	30 : 1	●	●	●
11/6 NHK	60	1890	63 x 1,5	12	29	24	230 ~	1,45	260	5	44	30 : 1	●	●	●
11/8 NHK	80	2520	63 x 1,5	15	29	24	230 ~	1,9	340	4	44	45 : 1	●	●	●
11/10 NHK	100	3150	63 x 1,5	12	29	24	230 ~	1,9	340	4	44	45 : 1	●	●	●
11/12 NHK	120	3780	63 x 1,5	12	29	24	230 ~	1,9	340	4	44	45 : 1			●

\*) 110–120 V; 210–240 V 60 Hz/100 V; 200 V 50 Hz on request